



Yealink Electronic Hook Switch (EHS) for Wireless Headset Use

Santiago Garcia - 2024-04-08 - Yealink Devices

Yealink Electronic Hook Switch (EHS) for Wireless Headset Use

Our team has tried many headsets over the years and we've found one in particular that works perfectly with the Yealink IP handsets.

We recommend the Plantronics CS540 for high volume users, combined with the Yealink EHS for wireless control. The Yealink EHS gives direct control of the phone with the ability to remotely answer and hang up phone calls from your headset.

Quick guide installation

1. **Extension Lead:** Connect the Extension lead to the phone's extension port and corresponding socket on the right side of the EHS (see 1).
2. **Headset Jack:** Connect the Headset lead to the phone and the corresponding headset port on the base station (see 2).
3. **EHS Power:** The EHS gets its power from the Plantronics base station so plug the EHS and base station (see 3 below).
4. **Base Station Power:** Plug into mains (see 4 below).

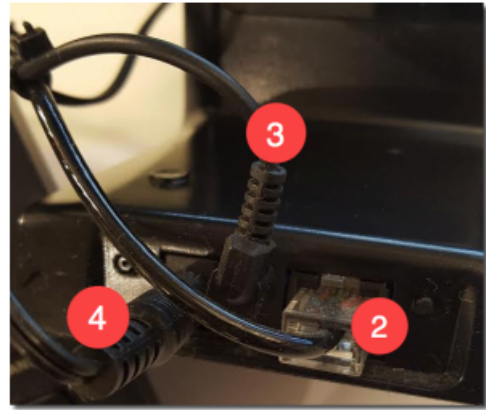

Tags
Device
Yealink